

## MALE END VIEW

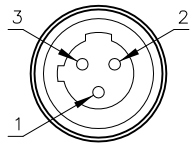

1 = NOT CONNECTED  
2 = L1  
3 = L2

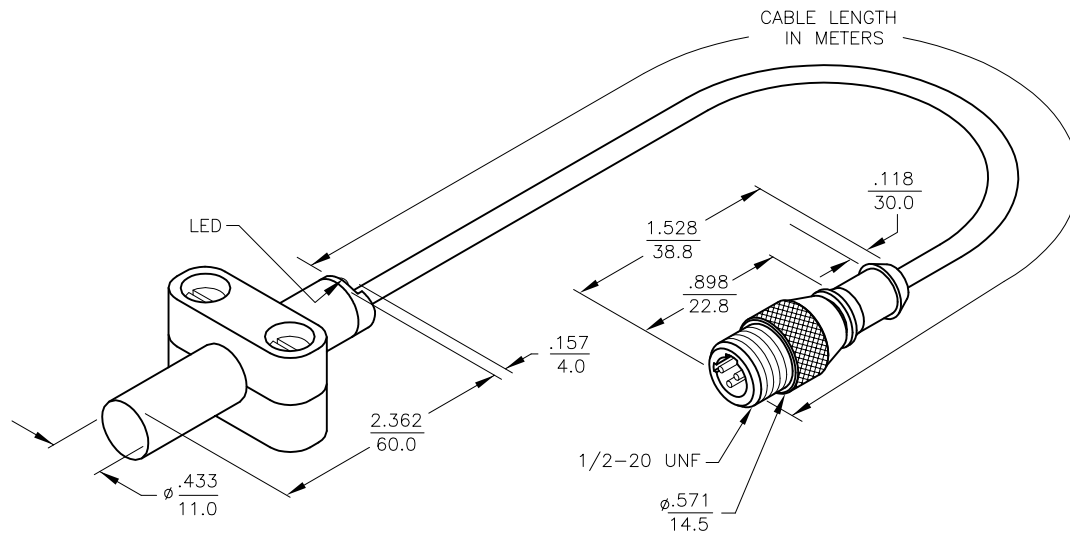

## SPECIFICATIONS

OPERATING VOLTAGE	20–250 VAC/10–300 VDC
LINE FREQUENCY	40–60 Hz
DIFFERENTIAL TRAVEL (HYSTERSIS)	3–15% (5% TYPICAL)
VOLTAGE DROP ACROSS CONDUCTING SENSOR	≤ 6.0 V @ 100 mA
OUTPUT FUNCTION –AZ	NORMALLY OPEN 2-WIRE AC SELF CONTAINED
SHORT–CIRCUIT PROTECTED	YES
CONTINUOUS LOAD CURRENT	≤ 100 mA
OVERLOAD TRIP CURRENT	> 220 mA
OFF–STATE (LEAKAGE) CURRENT	≤ 1.7 mA
MINIMUM LOAD CURRENT	≥ 3.0 mA
INRUSH CURRENT	≤ 1.0 A (≤ 30 ms/5Hz)
TIME DELAY BEFORE AVAILABILITY	≤ 60 ms
POWER–ON EFFECT PROTECTION	INCORPORATED
PROTECTION AGAINST TRANSIENTS	EN60947–5–2
OPERATING TEMPERATURE	–25°C TO +70°C (–13°F TO +158°F)
ENCLOSURE	MEETS NEMA 1,3,4,6,13 AND IEC IP67
SHOCK	30 g, 11 ms
VIBRATION	55 Hz, 1 mm AMPLITUDE (ALL 3 PLANES)
LED FUNCTION	RED: OUTPUT ENERGIZED RED FLASHING: OUTPUT SHORTED
SENSING RANGE	5 mm (.197") NOMINAL
SWITCHING FREQUENCY	60 Hz
REPEATABILITY	≤ 2% OF RATED OPERATING DISTANCE
EMBEDDABLE (SHIELDED)	NO
MATING PLUGS/CABLES	3–PIN <b>MICROFAST™</b> CONSTRUCTION

NOTE  
PRELIMINARY  
SPECIFICATIONS

RELATED DOCUMENTS 1. 2. 3. 4.	3RD ANGLE PROJECTION 	THIS DRAWING IS CONFIDENTIAL AND THE PROPERTY OF TURCK INC. USE OF THIS DOCUMENT WITHOUT WRITTEN PERMISSION IS PROHIBITED.		<b>TURCK</b> 3000 CAMPUS DRIVE MINNEAPOLIS, MN 55441 1-800-544-7769 (763) 553-7300 (763) 553-0708 fax www.turck.us	
	MATERIAL	DRFT CBM	DATE 11/13/98	DESCRIPTION NI5-K11-ADZ32X-0.2M-SB3T	
	FINISH	APVD	SCALE NONE		
CONTACT TURCK FOR MORE INFORMATION		UNIT OF MEASUREMENT <b>INCH [ MILLIMETER ]</b>		IDENTIFICATION NO. 4204690	
		DO NOT SCALE THIS DRAWING		REV P3	
P3	UPDATE ID NUMBER PER HARMONIZATION PROJECT	CBM	11/06/17	FILE: 4204690	
REV	DESCRIPTION	BY	DATE	ECO NO.	